

#### MHB MM Series—Medium-size Battery

- High performance, completely maintenance-free, low self-discharge
- 100% precise quality testing, stable quality and high reliable performance
- Unique grid alloy formula and updated manufacturing technique
- Floating & standby use: up to 8 years
- Cycle use 1: Up to 260 cycles at 100% DOD
- Cycle use 2: Up to 500 cycles at 50% DOD

#### Application:

- Telecommunications
- Alarm and security system
- Uninterruptable Power Supply (UPS)
- Communication power supply
- Electric Power System (EPS)
- DC power supply
- Emergency backup power supply
- Auto control system

#### Construction:

- Component .....Raw material
- Sealant .....Epoxy
- Positive .....Lead dioxide
- Safety valve .... Rubber
- Negative .....Lead
- Terminal .....Copper
- Container .....ABS
- Separator .....Fiber glass
- Cover .....ABS
- Electrolyte ..... Sulfuric acid

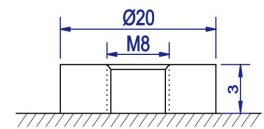

M8 Bolt

B5 Terminal

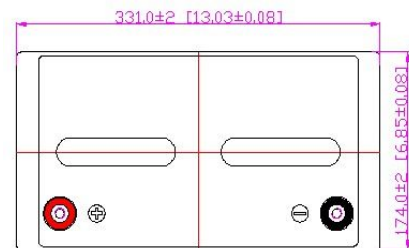
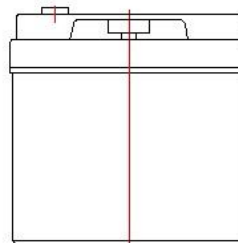
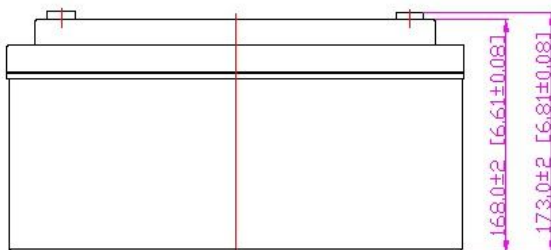

#### Specification:

Battery Model	MM 65-12 12V65AH			
Designed Floating Life	Up to 8 Years			
Capacity (25°C)	20HR(3.38A,10.8V)	10HR(6.50A,10.8V)	5HR(12.41A,10.5V)	1HR(41.54A,10.5V)
	67.60AH	65.00AH	62.05AH	41.54AH
Dimensions	Length	Width	Height	Total Height
	331mm (13.03inch)	174mm (6.85inch)	165mm (6.50inch)	168mm (6.61inch)
Approx. Weight	21.00Kg (46.31 lbs)±5%			
Internal Resistance	Full charged at 25°C: ≤8.0mΩ			
Self Discharge	2% of capacity declined per month at (25°C)			
Capacity Affected by Temp.(20HR)	40°C	25°C	0°C	-15°C
	102%	100%	85%	65%
Charge Voltage(25°C)	Cycle use		Float use	
	14.40-15.00V(-30mV/°C), max. Current:19.5A		13.50-13.80V (-20mV/°C)	

### Terminal Voltage (V) and Discharge Time

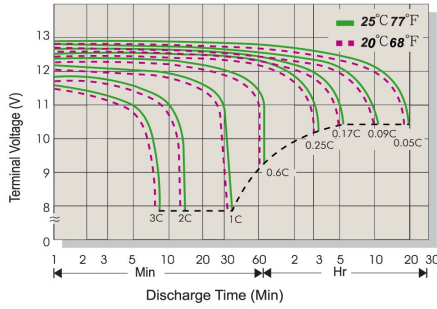

### Capacity Retention Characteristic

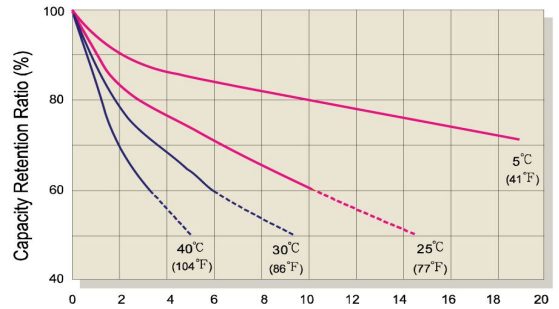

### Battery Voltage and Charge Time for Standby Use

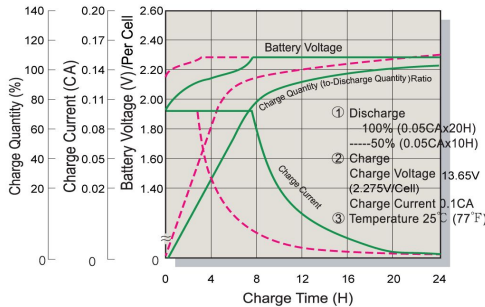

### Battery Voltage and Charge Time for Cycle Use

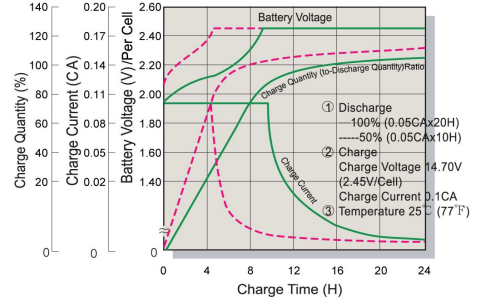

### Tickle(or Float) Service Life

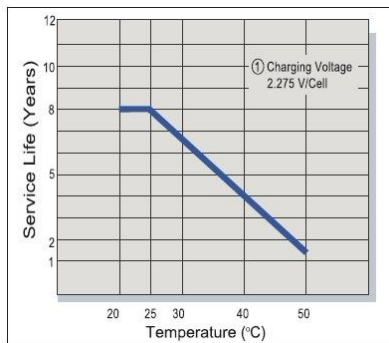

### Cycle Service Life

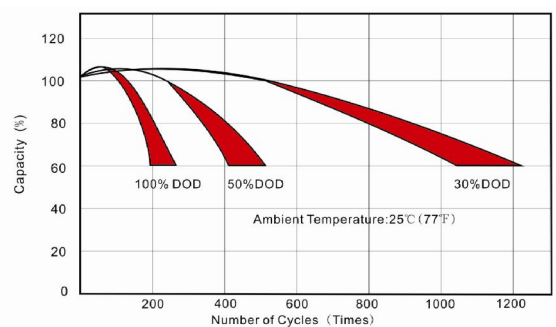

### Constant Current Discharge (CC, Unit: A) at 25°C (77°F)

F.V/Time	5Min	10Min	15Min	30Min	1Hr	2Hr	3Hr	4Hr	5Hr	6Hr	10Hr	20Hr
1.85V/Cell	226.70	133.83	105.18	68.56	40.01	23.13	17.76	14.59	11.95	9.74	6.39	3.32
1.80V/Cell	231.03	136.38	107.19	69.87	40.78	23.57	18.10	14.86	12.18	9.93	6.50	3.38
1.75V/Cell	235.36	138.94	109.20	71.18	41.54	24.01	18.44	15.14	12.41	10.12	6.63	3.45
1.70V/Cell	256.55	147.27	115.75	74.02	42.27	24.44	18.77	15.41	12.63	10.29	6.75	3.51
1.67V/Cell	282.44	159.78	125.58	78.16	42.73	24.70	18.97	15.57	12.76	10.40	6.82	3.55

### Constant Power Discharge (CP, Unit: W) at 25°C (77°F)

F.V/Time	5Min	10Min	15Min	30Min	1Hr	2Hr	3Hr	4Hr	5Hr	6Hr	10Hr	20Hr
1.85V/Cell	442.07	260.96	205.10	133.70	78.03	45.11	34.64	28.44	23.31	19.00	12.45	6.48
1.80V/Cell	450.51	265.94	209.02	136.25	79.52	45.97	35.30	28.99	23.75	19.36	12.68	6.60
1.75V/Cell	458.96	270.93	212.94	138.81	81.01	46.83	35.96	29.53	24.20	19.73	12.93	6.72
1.70V/Cell	500.26	287.19	225.71	144.34	82.44	47.65	36.59	30.05	24.62	20.07	13.16	6.84
1.67V/Cell	550.75	311.57	244.88	152.41	83.32	48.16	36.99	30.37	24.89	20.29	13.30	6.91